

IMMAGI  
NATIVE  
VEDDE  
SIGN

THE RESIDENCES

ANTARES

BARCELONA

## ICONIC LIVING – THE RESIDENCES

04 INTRODUCTION 06 RESIDENCES *Floor 02-07*  
12 RESIDENCES *Floor 08-18* 18 RESIDENCES *Floor 19-21*  
24 DUPLEX RESIDENCES *Floor 22-25*  
30 THE PENTHOUSES *Floor 26* 36 SERVICE RESIDENCES *Floor 01*  
38 URBAN LUXURY *Specification* 40 TEAM & CONTACT





# TEASES AND DARES

*Iconic living with a twist*

Wilfully unconventional, Antares is a design masterpiece from world-renowned architect Odile Decq. Her visionary design is bringing another iconic building to Barcelona, one of Europe's most attractive and culturally rich cities.

Antares is not just the highest residential tower in the city, it is a new 'landmark'. Uniquely positioned on Barcelona's famous shoreline, Antares sets a new benchmark in contemporary living.

The impeccably designed residences are awash with natural light due to floor-to-ceiling windows that give way to tranquil, private terraces offering spectacular views of the city and the sea. Working with interior designer HBA, Odile has combined exceptional open-plan layouts and high ceilings to provide a feeling of space. The seamless flooring running through each apartment

and out onto the terraces blurs the lines between inside and out, and further accentuates the idea of indoor-outdoor living.

Bespoke kitchens and signature features by the architect – such as kitchen islands, door handles and baths – further add to the sense of exclusivity.

However, it is not just the striking exterior and interior designs that make Antares stand out. The wide range of selective services and amenities offered to residents, including a fitness centre, indoor pool, cinema and a 100-metre high Sky Terrace & Rooftop infinity pool, further enhance the experience.

And Antares is all about unforgettable 'experiences', a living space that inspires.

# RESIDENCES

## FLOOR 02-07

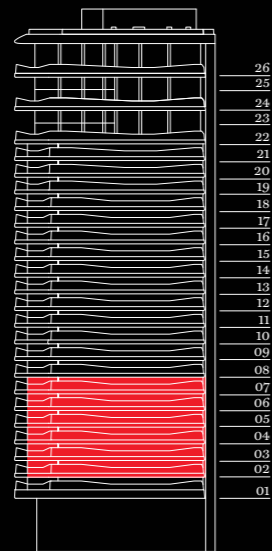

# RESIDENCES FLOOR 02-07

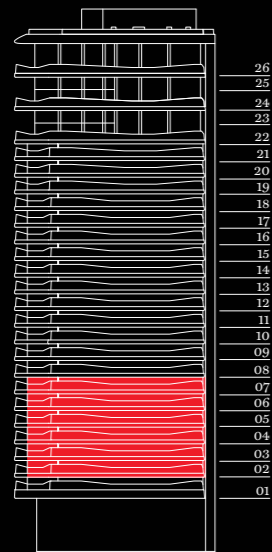

## RESIDENCES

### RESIDENCE TYPE 01

2.01 / 3.01 / 4.01 / 5.01 / 6.01 / 7.01

Living / Kitchen / Dining	6.5m x 6.1m
Master Bedroom	7.7m x 3.3m
Master Bathroom	4.1m x 3.0m
Bedroom 2	4.0m x 5.3m
Bathroom 2	2.2m x 4.5m
Net Internal Area	119.9 sq m
Gross Built Area	140.9 sq m

### RESIDENCE TYPE 02

2.02 / 3.02 / 4.02 / 5.02 / 6.02 / 7.02

Living / Kitchen / Dining	7.9m x 5.0m
Master Bedroom	5.4m x 3.6m
Master Bathroom	2.9m x 3.5m
Bedroom 2	5.4m x 2.7m
Bathroom 2	2.4m x 2.5m
Net Internal Area	85.8 sq m
Gross Built Area	97.8 sq m

### RESIDENCE TYPE 03

2.03 / 3.03 / 4.03 / 5.03 / 6.03 / 7.03

Living / Kitchen / Dining	8.2m x 7.7m
Master Bedroom	3.1m x 6.6m
Master Bathroom	2.6m x 3.5m
Bedroom 2	5.6m x 2.8m
Bathroom 2	2.4m x 2.6m
Net Internal Area	111.4 sq m
Gross Built Area	129.4 sq m

### RESIDENCE TYPE 04

2.04 / 3.04 / 4.04 / 5.04 / 6.04 / 7.04

Living / Kitchen / Dining	4.9m x 9.4m
Bedroom	5.2m x 5.7m
Bathroom	2.9m x 3.4m
Bathroom 2	1.0m x 2.5m
Net Internal Area	87.6 sq m
Gross Built Area	99.7 sq m

### RESIDENCE TYPE 05

2.05 / 3.05 / 4.05 / 5.05 / 6.05 / 7.05

Living / Kitchen / Dining	6.3m x 8.1m
Master Bedroom	4.4m x 6.6m
Master Bathroom	1.8m x 4.7m
Bedroom 2	3.1m x 4.0m
Bathroom 2	1.8m x 3.2m
Net Internal Area	108.2 sq m
Gross Built Area	127.8 sq m

## TERRACES

### RESIDENCE TYPE 01 TERRACES

RESIDENCE 2.01	RESIDENCE 4.01	RESIDENCE 6.01
Terrace 1 15.3 sq m	Terrace 1 15.3 sq m	Terrace 1 15.3 sq m
Terrace 2 27.4 sq m	Terrace 2 28.3 sq m	Terrace 2 29.1 sq m

### RESIDENCE 3.01

Terrace 1 15.3 sq m	Terrace 2 27.9 sq m
---------------------	---------------------

### RESIDENCE 5.01

Terrace 1 15.3 sq m	Terrace 2 28.7 sq m
---------------------	---------------------

### RESIDENCE 7.01

Terrace 1 15.3 sq m	Terrace 2 29.5 sq m
---------------------	---------------------

### RESIDENCE TYPE 02 TERRACES

RESIDENCE 2.02	RESIDENCE 4.02	RESIDENCE 6.02
Terrace 16.6 sq m	Terrace 16.6 sq m	Terrace 16.7 sq m

### RESIDENCE 3.02

Terrace 16.6 sq m
-------------------

### RESIDENCE 5.02

Terrace 16.6 sq m
-------------------

### RESIDENCE 7.02

Terrace 16.7 sq m
-------------------

### RESIDENCE TYPE 03 TERRACES

RESIDENCE 2.03	RESIDENCE 4.03	RESIDENCE 6.03
Terrace 45.3 sq m	Terrace 45.5 sq m	Terrace 45.7 sq m

### RESIDENCE 3.03

Terrace 45.4 sq m
-------------------

### RESIDENCE 5.03

Terrace 45.6 sq m
-------------------

### RESIDENCE 7.03

Terrace 45.8 sq m
-------------------

### RESIDENCE TYPE 04 TERRACES

RESIDENCE 2.04	RESIDENCE 4.04	RESIDENCE 6.04
Terrace 22.5 sq m	Terrace 22.6 sq m	Terrace 22.8 sq m

### RESIDENCE 3.04

Terrace 22.6 sq m
-------------------

### RESIDENCE 5.04

Terrace 22.7 sq m
-------------------

### RESIDENCE 7.04

Terrace 22.8 sq m
-------------------

### RESIDENCE TYPE 05 TERRACES

RESIDENCE 2.05	RESIDENCE 4.05	RESIDENCE 6.05
Terrace 1 21.3 sq m	Terrace 1 21.4 sq m	Terrace 1 21.5 sq m
Terrace 2 17.1 sq m	Terrace 2 16.9 sq m	Terrace 2 16.7 sq m

### RESIDENCE 3.05

Terrace 1 21.4 sq m	Terrace 2 17.0 sq m
---------------------	---------------------

### RESIDENCE 5.05

Terrace 1 21.5 sq m	Terrace 2 16.8 sq m
---------------------	---------------------

### RESIDENCE 7.05

Terrace 1 21.6 sq m	Terrace 2 16.6 sq m
---------------------	---------------------

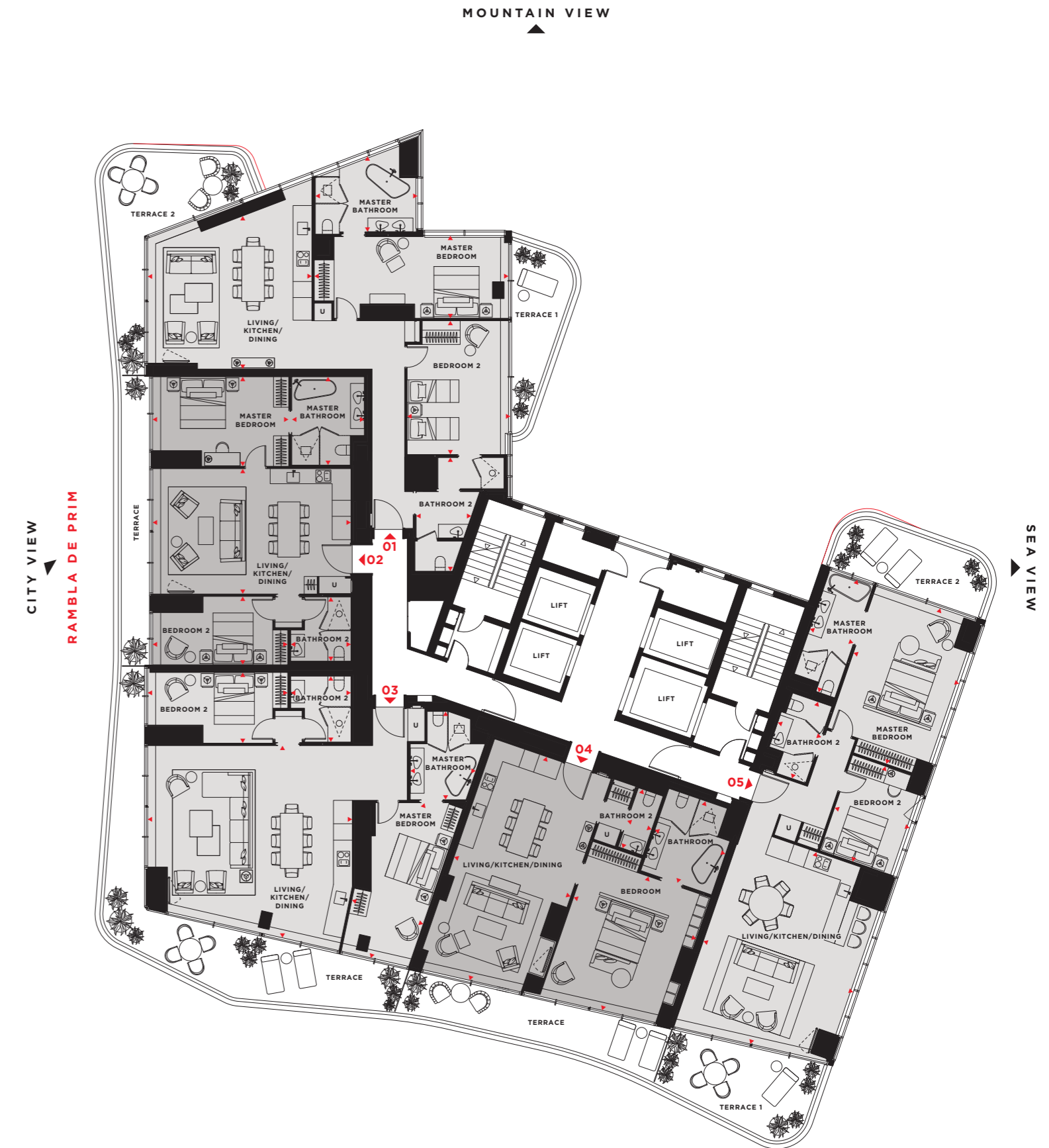

0 1 2 3 4 5m

AV. D'EDUARD MARISTANY

SEA VIEW

NORTH

\*Floor plan illustrations show the layout of the accommodation only, are not to scale, and must not be relied upon as a statement of fact.



LIVING & KITCHEN  
Open-plan spaces with  
floor-to-ceiling windows  
for high impact



*This page*  
**BATHROOM**  
*Bright and spacious with unique vanity and bath units designed by Odile Decq*  
*Opposite page*  
**BEDROOM**  
*Spacious layout with private terraces and abundance of natural light*





# RESIDENCES FLOOR 08-18

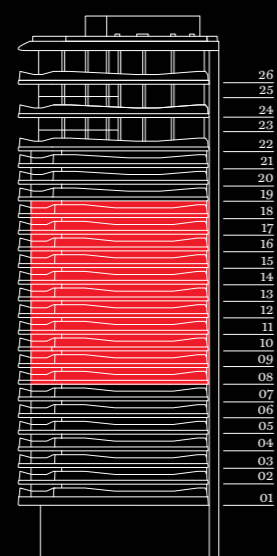

# RESIDENCES FLOOR 08-18

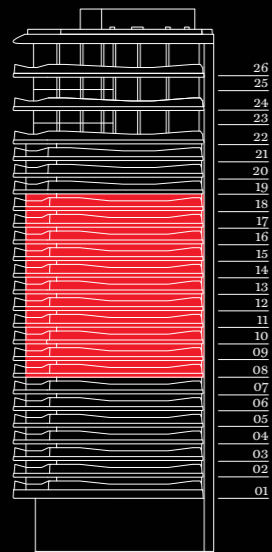

## RESIDENCES

### RESIDENCE TYPE 01

08.01 / 09.01 / 10.01 / 11.01 / 12.01 / 13.01 / 14.01 / 15.01 / 16.01 / 17.01 / 18.01

Kitchen / Dining	6.1m x 6.7m
Living	6.6m x 6.3m
Master Bedroom	7.7m x 3.3m
Master Bathroom	4.1m x 3.0m
Bedroom 2	4.7m x 5.4m
Bathroom 2	3.2m x 3.0m
Bedroom 3	5.7m x 3.6m
Bathroom 3	2.2m x 3.2m
Bathroom 4	2.3m x 2.9m

Net Internal Area	197.1 sq m
Gross Built Area	227.5 sq m

### RESIDENCE TYPE 02

08.02 / 09.02 / 10.02 / 11.02 / 12.02 / 13.02 / 14.02 / 15.02 / 16.02 / 17.02 / 18.02

Living / Kitchen / Dining	8.1m x 8.0m
Master Bedroom	4.7m x 4.5m
Master Dressing Room	3.3m x 1.8m
Master Bathroom	3.8m x 2.5m
Bedroom 2	3.7m x 7.1m
Bathroom 2	3.0m x 2.6m
Bedroom 3	3.6m x 6.3m
Bathroom 3	2.9m x 2.1m

Net Internal Area	171.1 sq m
Gross Built Area	194.1 sq m

### RESIDENCE TYPE 03

08.03 / 09.03 / 10.03 / 11.03 / 12.03 / 13.03 / 14.03 / 15.03 / 16.03 / 17.03 / 18.03

Living / Kitchen / Dining	9.5m x 8.2m
Master Bedroom	4.4m x 6.6m
Master Bathroom	1.8m x 4.6m
Bedroom 2	3.6m x 6.0m
Bathroom 2	2.7m x 2.9m
Bedroom 3	3.1m x 4.0m
Bathroom 3	1.8m x 2.6m

Net Internal Area	159.9 sq m
Gross Built Area	184.7 sq m

## TERRACES

### RESIDENCE TYPE 01 TERRACES

<b>RESIDENCE 8.01</b>	<b>RESIDENCE 12.01</b>	<b>RESIDENCE 16.01</b>
Terrace 1 15.3 sq m	Terrace 1 15.3 sq m	Terrace 1 15.3 sq m
Terrace 2 41.8 sq m	Terrace 2 43.0 sq m	Terrace 2 44.0 sq m

<b>RESIDENCE 9.01</b>	<b>RESIDENCE 13.01</b>	<b>RESIDENCE 17.01</b>
Terrace 1 15.3 sq m	Terrace 1 15.3 sq m	Terrace 1 15.3 sq m
Terrace 2 42.1 sq m	Terrace 2 43.3 sq m	Terrace 2 44.1 sq m

<b>RESIDENCE 10.01</b>	<b>RESIDENCE 14.01</b>	<b>RESIDENCE 18.01</b>
Terrace 1 15.3 sq m	Terrace 1 15.3 sq m	Terrace 1 15.3 sq m
Terrace 2 42.4 sq m	Terrace 2 43.5 sq m	Terrace 2 44.3 sq m

<b>RESIDENCE 11.01</b>	<b>RESIDENCE 15.01</b>	
Terrace 1 15.3 sq m	Terrace 1 15.3 sq m	
Terrace 2 42.8 sq m	Terrace 2 43.8 sq m	

### RESIDENCE TYPE 02 TERRACES

<b>RESIDENCE 8.02</b>	<b>RESIDENCE 12.02</b>	<b>RESIDENCE 16.02</b>
Terrace 57.9 sq m	Terrace 58.0 sq m	Terrace 57.3 sq m

<b>RESIDENCE 9.02</b>	<b>RESIDENCE 13.02</b>	<b>RESIDENCE 17.02</b>
Terrace 58.0 sq m	Terrace 57.9 sq m	Terrace 57.0 sq m

<b>RESIDENCE 10.02</b>	<b>RESIDENCE 14.02</b>	<b>RESIDENCE 18.02</b>
Terrace 58.0 sq m	Terrace 57.8 sq m	Terrace 56.7 sq m

<b>RESIDENCE 11.02</b>	<b>RESIDENCE 15.02</b>	
Terrace 58.0 sq m	Terrace 57.6 sq m	

### RESIDENCE TYPE 03 TERRACES

<b>RESIDENCE 8.03</b>	<b>RESIDENCE 12.03</b>	<b>RESIDENCE 16.03</b>
Terrace 1 35.4 sq m	Terrace 1 35.7 sq m	Terrace 1 36.1 sq m
Terrace 2 16.4 sq m	Terrace 2 16.2 sq m	Terrace 2 16.3 sq m

<b>RESIDENCE 9.03</b>	<b>RESIDENCE 13.03</b>	<b>RESIDENCE 17.03</b>
Terrace 1 35.5 sq m	Terrace 1 35.8 sq m	Terrace 1 36.2 sq m
Terrace 2 16.4 sq m	Terrace 2 16.2 sq m	Terrace 2 16.3 sq m

<b>RESIDENCE 10.03</b>	<b>RESIDENCE 14.03</b>	<b>RESIDENCE 18.03</b>
Terrace 1 35.6 sq m	Terrace 1 35.9 sq m	Terrace 1 36.3 sq m
Terrace 2 16.3 sq m	Terrace 2 16.2 sq m	Terrace 2 16.4 sq m

<b>RESIDENCE 11.03</b>	<b>RESIDENCE 15.03</b>	
Terrace 1 35.7 sq m	Terrace 1 36.0 sq m	
Terrace 2 16.2 sq m	Terrace 2 16.2 sq m	

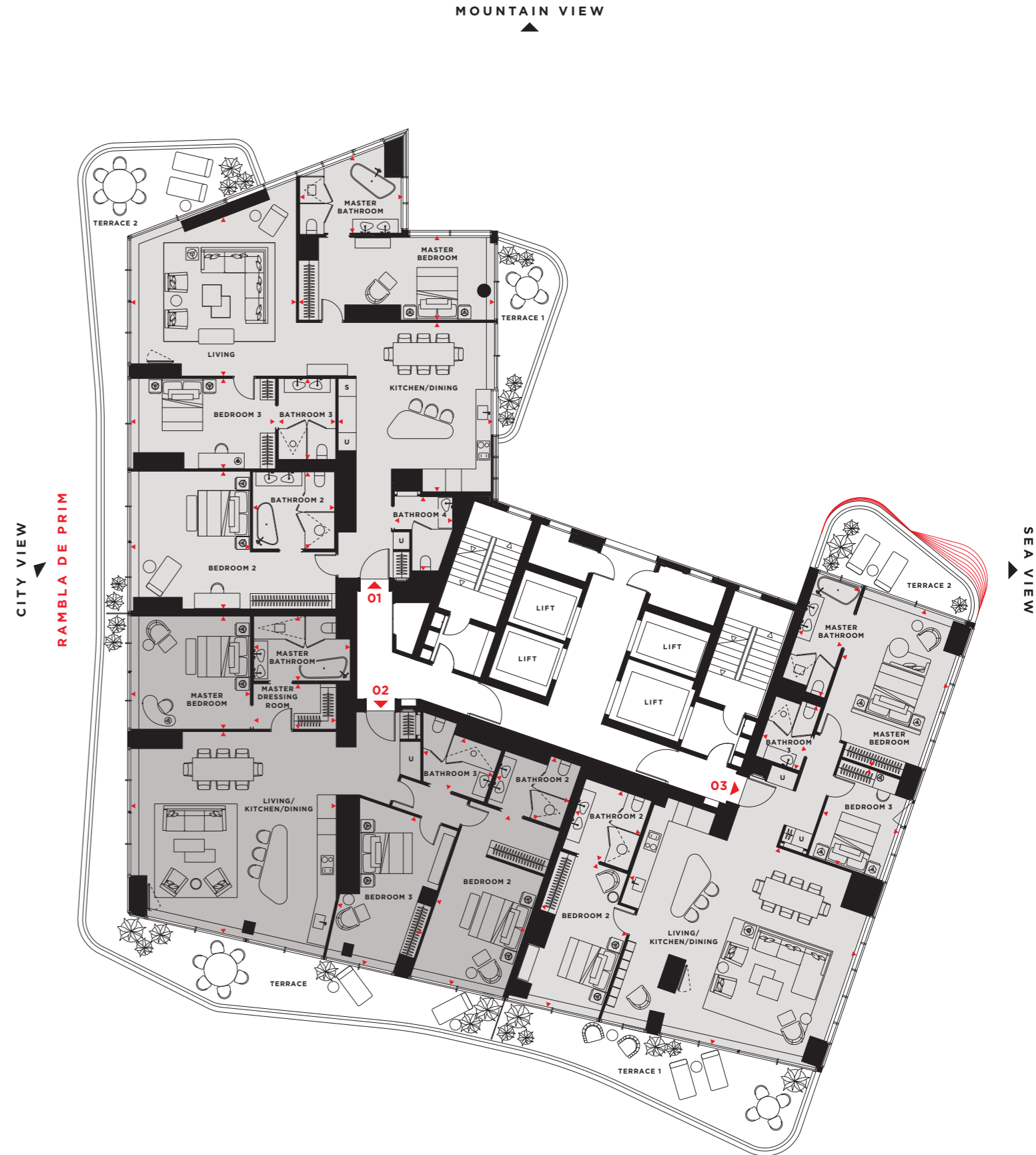

AV. D'EDUARD MARISTANY

\*Floor plan illustrations show the layout of the accommodation only, are not to scale, and must not be relied upon as a statement of fact.



KITCHEN & LIVING AREA  
*Generous layout for inside  
and outside living*



SECOND BATHROOM  
*Many of the bathroom features  
have been exclusively designed  
by the architect Odile Decq*

# RESIDENCES FLOOR 19-21

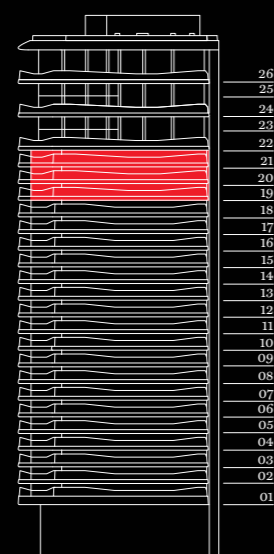

# RESIDENCES FLOOR 19-21

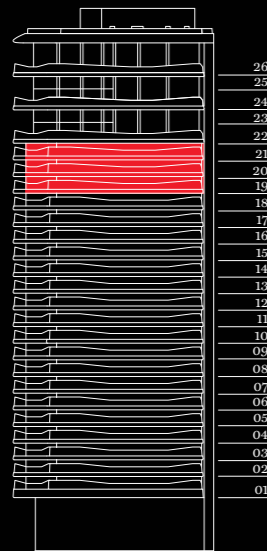

## RESIDENCES

### RESIDENCE TYPE 01

19.01 / 20.01 / 21.01

Living / Kitchen / Dining	13.0m x 13.8m
Master Bedroom	6.5m x 6.3m
Master Dressing Room	2.1m x 2.4m
Master Bathroom	4.1m x 6.8m
Bedroom 2	5.0m x 5.1m
Bathroom 2	2.9m x 2.9m
Bedroom 3	3.6m x 8.7m
Bathroom 3	2.8m x 2.5m
Bedroom 4	5.0m x 4.1m
Bathroom 4	2.9m x 1.8m
Bathroom 5	1.9m x 1.7m

Net Internal Area	344.1 sq m
Gross Built Area	386.1 sq m

### RESIDENCE TYPE 02

19.02 / 20.02 / 21.02

Living / Kitchen / Dining	12.4m x 9.0m
Master Bedroom	4.4m x 6.6m
Master Bathroom	1.8m x 4.6m
Bedroom 2	4.3m x 6.7m
Bathroom 2	4.2m x 2.6m
Bedroom 3	3.1m x 4.0m
Bathroom 3	1.8m x 2.7m

Net Internal Area	201.7 sq m
Gross Built Area	229.5 sq m

## TERRACES

### RESIDENCE TYPE 01 TERRACES

RESIDENCE 19.01

Terrace 1	15.3 sq m
Terrace 2	91.5 sq m

RESIDENCE 20.01

Terrace 1	15.3 sq m
Terrace 2	91.2 sq m

RESIDENCE 21.01

Terrace 1	15.3 sq m
Terrace 2	90.8 sq m

### RESIDENCE TYPE 02 TERRACES

RESIDENCE 19.02

Terrace 1	45.6 sq m
Terrace 2	16.5 sq m

RESIDENCE 20.02

Terrace 1	45.7 sq m
Terrace 2	16.6 sq m

RESIDENCE 21.02

Terrace 1	45.8 sq m
Terrace 2	16.7 sq m

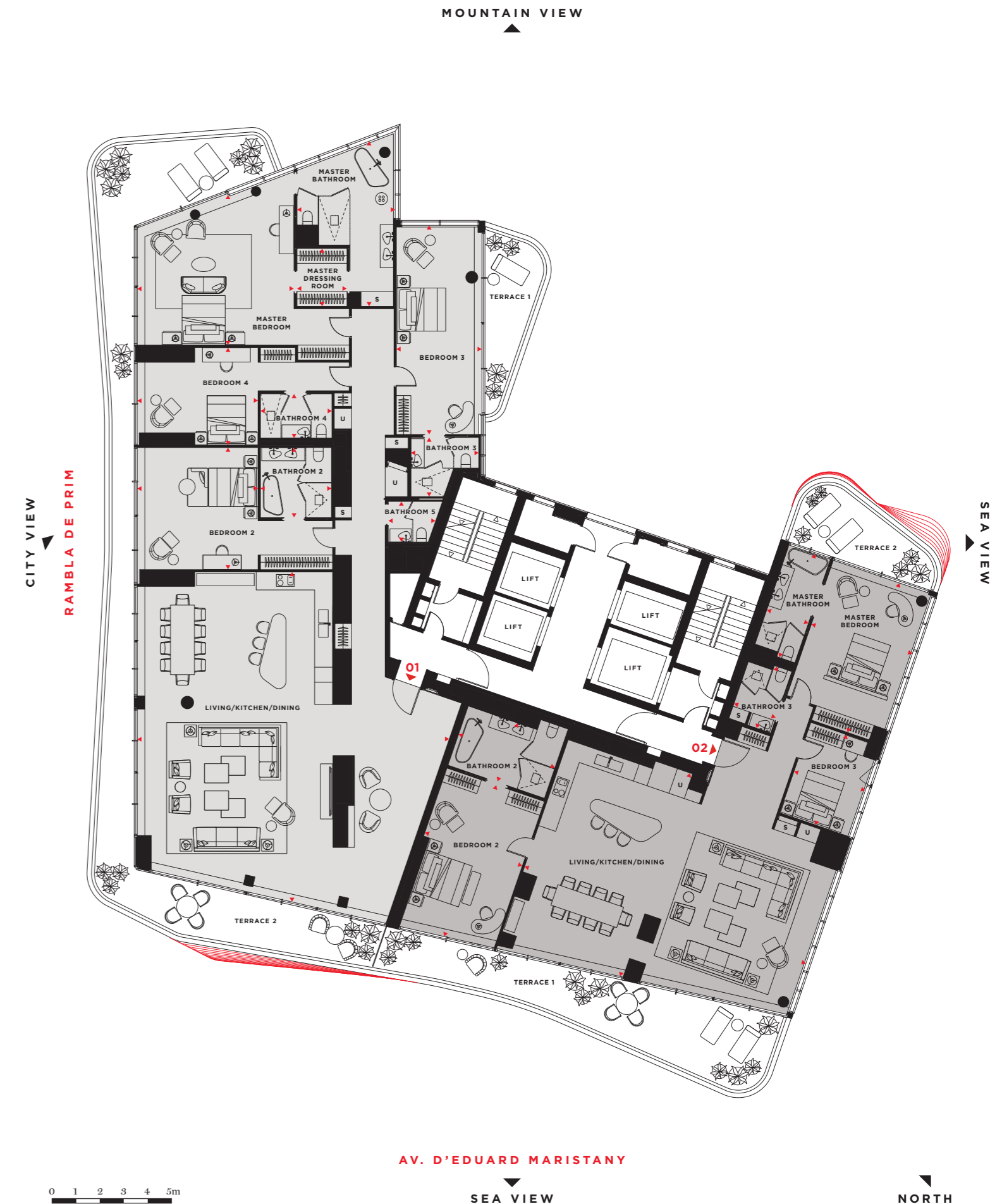

\*Floor plan illustrations show the layout of the accommodation only, are not to scale, and must not be relied upon as a statement of fact.



LIVING, DINING & TERRACE  
Floor-to-ceiling windows allow  
light to flood in and provide  
dramatic sea views



MASTER BEDROOM  
Panoramic views of the city  
for pure relaxation



# DUPLEX RESIDENCES

## FLOOR 22-25

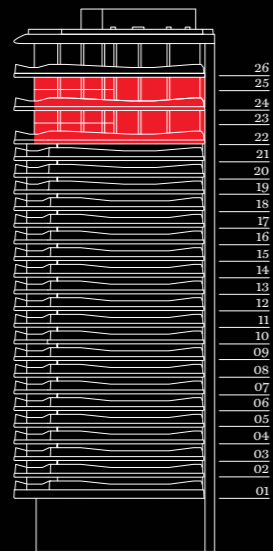

## FLOOR 22 & 24 LOWER LEVEL

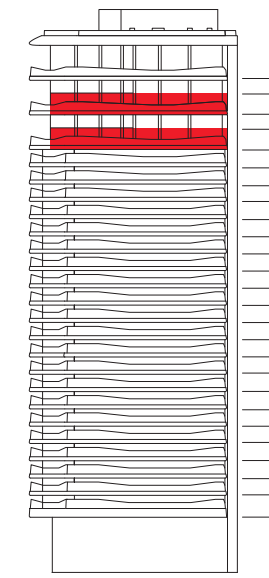

### RESIDENCES

#### RESIDENCE TYPE 01

22.01 / 24.01 (Lower level)

Living / Kitchen / Dining	12.7m x 10.5m
Bedroom 2	7.7m x 3.3m
Bathroom 2	4.1m x 3.0m
Bathroom 5	2.3m x 3.1m
Net Internal Area	143.8 sq m
Gross Built Area	159.7 sq m

Total Residence Internal Area	268.6 sq m
Total Residence Gross Built Area	302.7 sq m

#### RESIDENCE TYPE 02

22.02 / 24.02 (Lower level)

Living / Kitchen / Dining	10.2m x 17.1m
Bedroom 3	4.5m x 5.2m
Bathroom 3	3.4m x 2.8m
Bathroom 4	2.1m x 2.6m
Net Internal Area	175.9 sq m
Gross Built Area	194.4 sq m

Total Residence Internal Area	273.9 sq m
Total Residence Gross Built Area	306.0 sq m

#### RESIDENCE TYPE 03

22.03 / 24.03 (Lower level)

Living / Kitchen / Dining	12.4m x 8.8m
Bedroom 2	4.4m x 4.8m
Bathroom 2	1.8m x 4.6m
Bedroom 4	3.1m x 3.5m
Bathroom 4	1.8m x 2.8m
Net Internal Area	143.0 sq m
Gross Built Area	162.4 sq m

Total Residence Internal Area	236.4 sq m
Total Residence Gross Built Area	272.6 sq m

Total Residence Internal Area	236.4 sq m
Total Residence Gross Built Area	272.6 sq m

### TERRACES

#### RESIDENCE TYPE 01 TERRACES

RESIDENCE 22.01 (Lower level)

Terrace 1	15.3 sq m
Terrace 2	51.6 sq m

RESIDENCE 24.01 (Lower level)

Terrace 1	15.3 sq m
Terrace 2	51.7 sq m

#### RESIDENCE TYPE 02 TERRACES

RESIDENCE 22.02 (Lower level)

Terrace	115.8 sq m
---------	------------

RESIDENCE 24.02 (Lower level)

Terrace	114.7 sq m
---------	------------

#### RESIDENCE TYPE 03 TERRACES

RESIDENCE 22.03 (Lower level)

Terrace 1	58.3 sq m
Terrace 2	16.8 sq m

RESIDENCE 24.03 (Lower level)

Terrace 1	58.5 sq m
Terrace 2	17.1 sq m

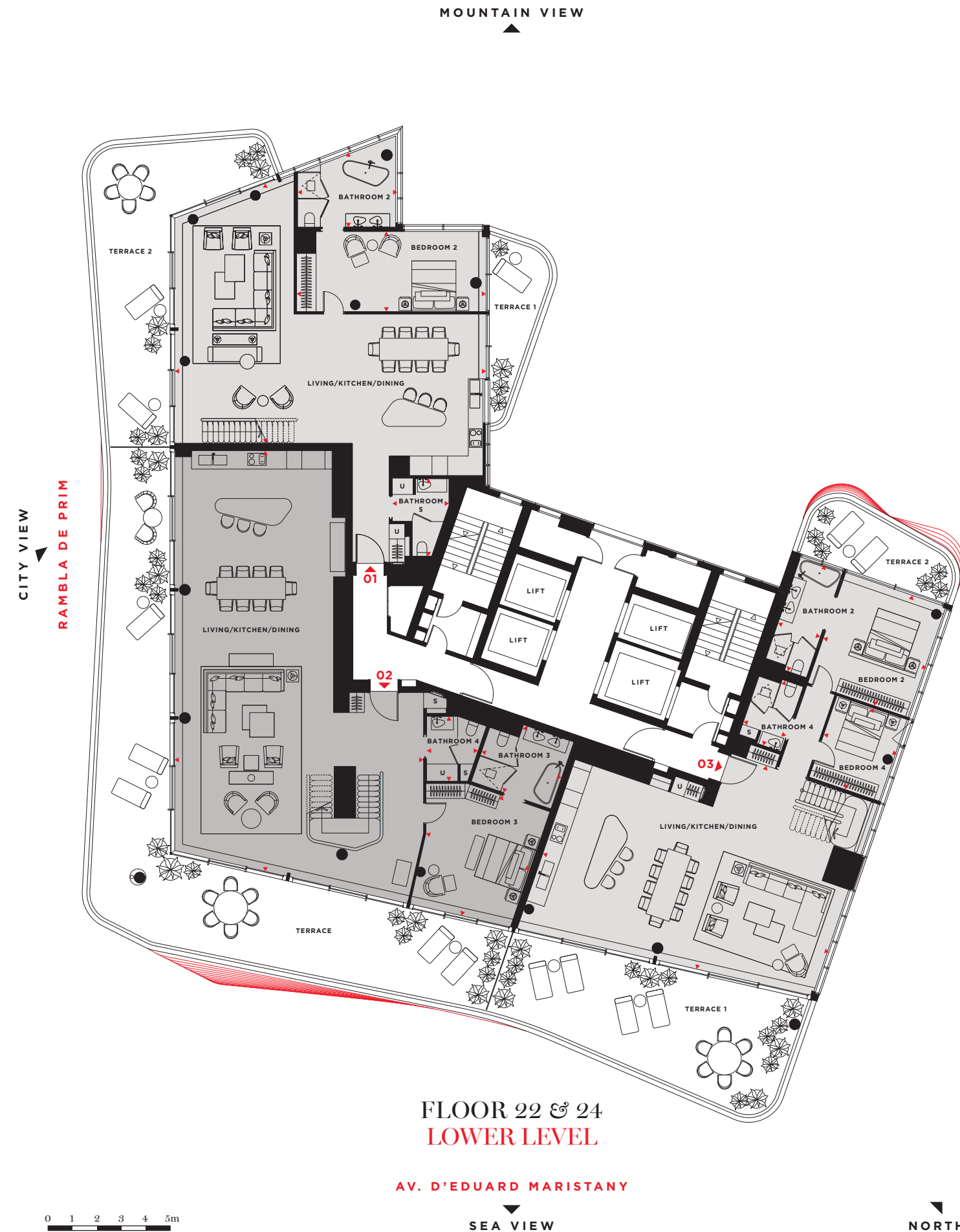

FLOOR 22 & 24  
LOWER LEVEL

AV. D'EDUARD MARISTANY

SEA VIEW

NORTH

## FLOOR 23 & 25 UPPER LEVEL

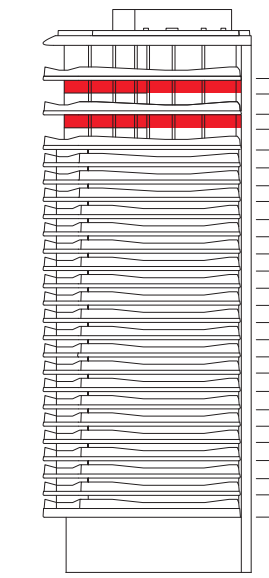

### RESIDENCES

#### RESIDENCE TYPE 01

23.01 / 25.01 (Upper level)

Master Bedroom	7.7m x 4.9m
Master Bathroom	4.1m x 3.0m
Bedroom 3	4.4m x 4.3m
Bathroom 3	1.8m x 3.6m
Living	6.5m x 4.7m
Bathroom 4	2.3m x 3.2m
Net Internal Area	124.8 sq m
Gross Built Area	143.0 sq m

Total Residence Internal Area	268.6 sq m
Total Residence Gross Built Area	302.7 sq m

#### RESIDENCE TYPE 02

23.02 / 25.02 (Upper level)

Master Bedroom	4.1m x 6.4m
Master Bathroom	2.3m x 4.2m
Bedroom 2	4.5m x 5.4m
Bathroom 2	5.1m x 2.1m
Net Internal Area	98.0 sq m
Gross Built Area	111.6 sq m

Total Residence Internal Area	273.9 sq m
Total Residence Gross Built Area	306.0 sq m

#### RESIDENCE TYPE 03

23.03 / 25.03 (Upper level)

Master Bedroom	6.4m x 8.4m
Master Bathroom	1.8m x 4.8m
Bedroom 3	3.5m x 4.5m
Bathroom 3	2.1m x 2.6m
Net Internal Area	93.4 sq m
Gross Built Area	110.2 sq m

Total Residence Internal Area	236.4 sq m
Total Residence Gross Built Area	272.6 sq m

Total Residence Internal Area	236.4 sq m
Total Residence Gross Built Area	272.6 sq m

### TERRACES

#### RESIDENCE TYPE 01 TERRACES

RESIDENCE 23.01 (Upper level)

Terrace 1	15.3 sq m
Terrace 2	14.1 sq m

RESIDENCE 25.01 (Upper level)

Terrace 1	15.3 sq m
Terrace 2	14.2 sq m

#### RESIDENCE TYPE 02 TERRACES

RESIDENCE 23.02 (Upper level)

Terrace 1	21.4 sq m
Terrace 2	18.7 sq m

RESIDENCE 25.02 (Upper level)

Terrace 1	21.6 sq m
Terrace 2	18.5 sq m

#### RESIDENCE TYPE 03 TERRACES

RESIDENCE 23.03 (Upper level)

Terrace 1	14.0 sq m
Terrace 2	17.0 sq m

RESIDENCE 25.03 (Upper level)

Terrace 1	14.1 sq m
Terrace 2	17.1 sq m



FLOOR 23 & 25  
UPPER LEVEL

AV. D'EDUARD MARISTANY

SEA VIEW

NORTH

\*Floor plan illustrations show the layout of the accommodation only, are not to scale, and must not be relied upon as a statement of fact.





*This page*

**KITCHEN**

*High-specification finishes and  
bespoke kitchen island by Odile Decq*

*Opposite page*

**LIVING, KITCHEN & TERRACE**

*Impressive space designed over two floors  
with double-height ceilings*

# THE PENTHOUSES

## FLOOR 26

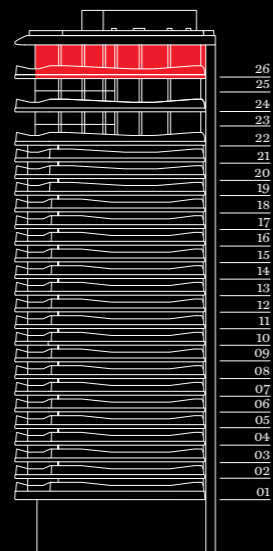

# THE PENTHOUSES

## FLOOR 26

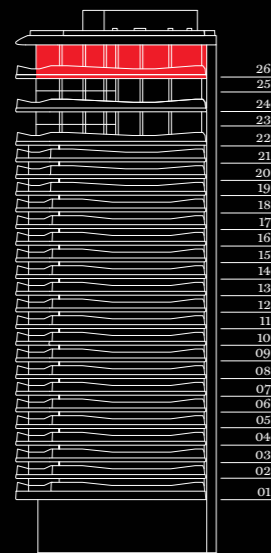

### RESIDENCES

#### RESIDENCE TYPE 01

##### 26.01

Living / Kitchen / Dining	9.7m x 17.5m
Master Bedroom	4.9m x 7.1m
Master Dressing Room	2.2m x 3.0m
Master Bathroom	4.8m x 3.0m
Bedroom 2	7.7m x 3.3m
Bathroom 2	4.1m x 3.0m
Bedroom 3	3.8m x 5.3m
Bathroom 3	2.8m x 2.4m
Bathroom 4	1.9m x 1.7m

Net Internal Area	275.7 sq m
Gross Built Area	310.6 sq m

#### RESIDENCE TYPE 02

##### 26.02

Living / Kitchen / Dining	12.4m x 8.6m
Master Bedroom	3.8m x 8.4m
Master Bathroom	2.3m x 4.4m
Bedroom 2	5.0m x 5.0m
Dressing Room	1.8m x 2.5m
Bathroom 2	3.7m x 3.1m
Bathroom 3	2.4m x 1.9m

Net Internal Area	181.9 sq m
Gross Built Area	205.7 sq m

### TERRACES

#### RESIDENCE TYPE 01 TERRACES

##### RESIDENCE 26.01

Terrace 1	15.3 sq m
Terrace 2	148.5 sq m

#### RESIDENCE TYPE 02 TERRACES

##### RESIDENCE 26.02

Terrace 1	75.1 sq m
Terrace 2	17.2 sq m

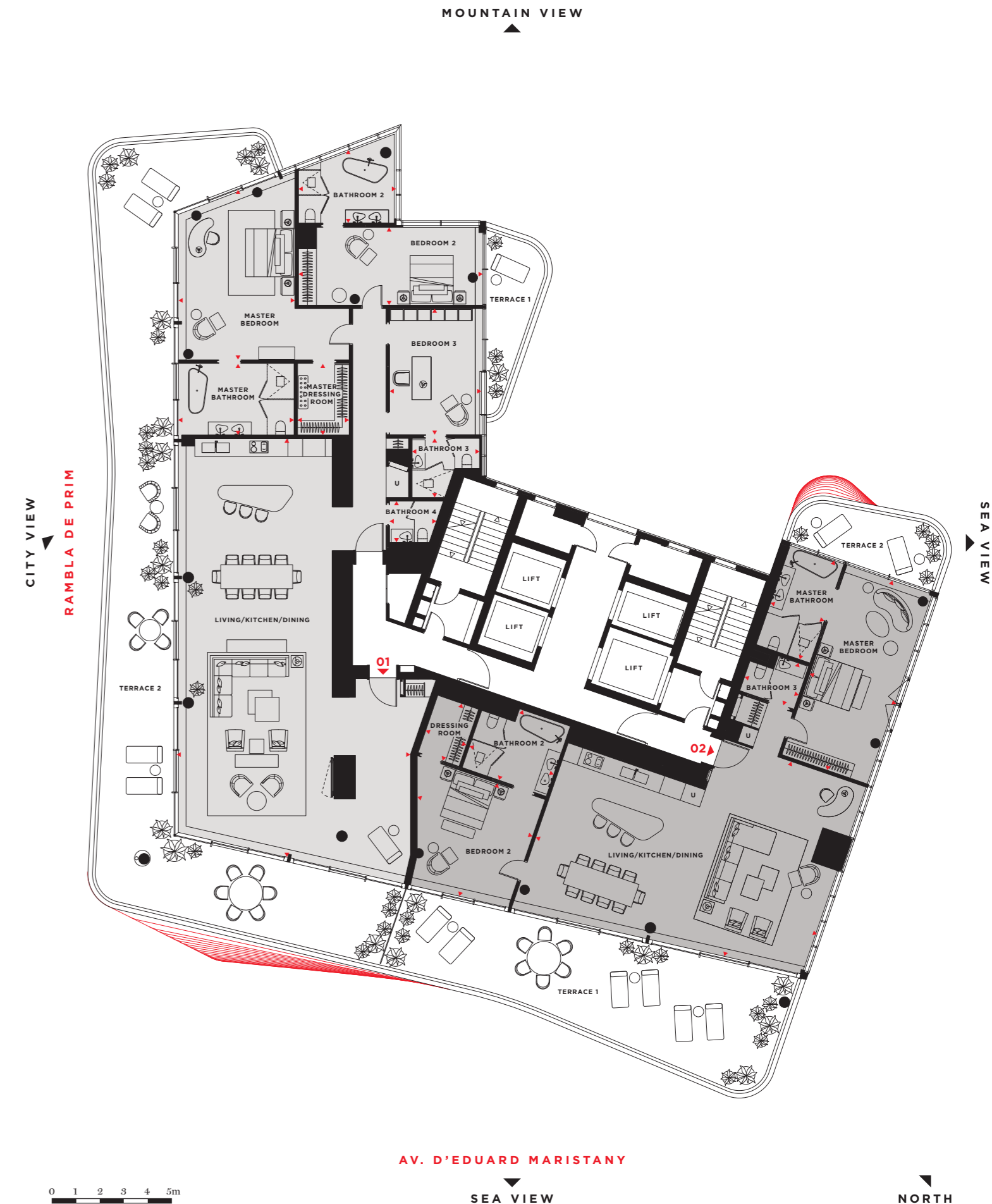

\*Floor plan illustrations show the layout of the accommodation only, are not to scale, and must not be relied upon as a statement of fact.



LIVING & TERRACE  
*Terraces with unparalleled  
panoramic views*



LIVING & TERRACE  
*Dramatic and impactful  
double-height living space*



# SERVICE RESIDENCES

## FLOOR 01

### RESIDENCE TYPE 01

<b>1.01</b>	
Living / Kitchen / Dining	3.9m x 6.5m
Bedroom	3.8m x 3.3m
Bathroom	2.2m x 3.6m
Net Internal Area	42.6 sq m
Gross Built Area	50.4 sq m
Terrace	15.3 sq m

### RESIDENCE TYPE 02

<b>1.02</b>	
Living / Kitchen / Dining	6.6m x 3.7m
Bedroom	4.2m x 3.0m
Bathroom	2.0m x 2.6m
Net Internal Area	47.5 sq m
Gross Built Area	58.0 sq m
Terrace	23.0 sq m

### RESIDENCE TYPE 03

<b>1.03</b>	
Living / Kitchen / Dining	8.5m x 2.8m
Bedroom	5.9m x 2.8m
Bathroom	3.1m x 1.9m
Net Internal Area	40.4 sq m
Gross Built Area	45.9 sq m
Terrace	8.2 sq m

### RESIDENCE TYPE 04

<b>1.04</b>	
Living / Kitchen / Dining	8.5m x 2.5m
Bedroom	5.1m x 3.1m
Bathroom	2.7m x 1.5m
Net Internal Area	41.8 sq m
Gross Built Area	47.8 sq m
Terrace	8.2 sq m

### RESIDENCE TYPE 05

<b>1.05</b>	
Living / Kitchen / Dining	8.5m x 2.6m
Bedroom	5.1m x 3.1m
Bathroom	2.6m x 1.5m
Net Internal Area	41.4 sq m
Gross Built Area	49.5 sq m
Terrace	8.7 sq m

### RESIDENCE TYPE 06

<b>1.06</b>	
Living / Kitchen / Dining	4.9m x 4.3m
Bedroom	4.1m x 2.8m
Bathroom	2.9m x 1.7m
Net Internal Area	46.5 sq m
Gross Built Area	54.5 sq m
Terrace	25.1 sq m

### RESIDENCE TYPE 07

<b>1.07</b>	
Living / Kitchen / Dining	3.0m x 7.1m
Bedroom	3.1m x 4.8m
Bathroom	1.5m x 2.4m
Net Internal Area	43.1 sq m
Gross Built Area	51.2 sq m
Terrace	15.8 sq m

### RESIDENCE TYPE 08

<b>1.08</b>	
Living / Kitchen / Dining	2.1m x 9.9m
Bedroom	2.9m x 6.8m
Bathroom	1.5m x 2.7m
Net Internal Area	44.5 sq m
Gross Built Area	51.9 sq m
Terrace	10.6 sq m

### RESIDENCE TYPE 09

<b>1.09</b>	
Living / Kitchen / Dining	2.9m x 9.0m
Master Bedroom	2.6m x 6.1m
Bathroom 1	1.6m x 2.8m
Bedroom 2	2.0m x 5.2m
Bathroom 2	1.6m x 2.6m
Net Internal Area	63.9 sq m
Gross Built Area	74.2 sq m
Terrace	18.9 sq m

### RESIDENCE TYPE 10

<b>1.10</b>	
Living / Kitchen / Dining	3.9m x 5.7m
Bedroom	3.9m x 2.9m
Bathroom	3.0m x 2.2m
Net Internal Area	40.1 sq m
Gross Built Area	49.1 sq m
Terrace	14.3 sq m

### RESIDENCE TYPE 11

<b>1.11</b>	
Living / Kitchen / Dining	6.4m x 3.8m
Bedroom	4.4m x 3.4m
Bathroom	1.8m x 3.5m
Net Internal Area	40.9 sq m
Gross Built Area	49.5 sq m
Terrace	13.5 sq m

CITY VIEW

RAMBLA DE PRIM



AV. D'EDUARD MARISTANY

SEA VIEW

NORTH

\*Floor plan illustrations show the layout of the accommodation only, are not to scale, and must not be relied upon as a statement of fact.

*Urban luxury – The specification.* WHERE DESIGN VISION IS UNDERPINNED BY WORLD-CLASS EXECUTION, THE FINEST MATERIALS AND STATE-OF-THE-ART TECHNOLOGY.



KITCHEN  
Exquisite design meets  
functionality and quality  
to the highest standard

#### KITCHENS

##### *Service Residences (Floor 01)*

- Bespoke-designed fitted kitchen, high and low cabinets, soft-closing doors and drawers in lacquered finish
- White solid surface countertop and backsplash
- Dornbracht Elio mixer in chrome
- Siemens appliances

##### *Floor 02-07*

- Bespoke-designed fitted kitchen, high and low cabinets, soft-closing doors and drawers in lacquered finish
- White solid surface countertop and backsplash
- Solid surface sink with Dornbracht sink mixer and side spray
- Miele appliances: oven, microwave, induction hobs, hood, fridge-freezer (75cm), dishwasher and stacked washing machine & dryer

##### *Floor 08-18*

As previous with the following enhancements:

- Solid surface kitchen island designed by Odile Decq
- Miele appliances: combi oven/steam oven, plate warmer, wine cooler and fridge-freezer (90cm)

##### *Floor 19-21*

As previous with the following enhancements:

- Natural stone countertop and backsplash
- Dornbracht steel sink
- Miele appliances: vacuum seal drawer and side by side fridge-freezer (120cm) with ice and water dispenser

##### *Duplex and Penthouse Residences*

Includes all enhanced features as previously described

#### BATHROOMS & ENSUITES

##### *Service Residences (Floor 01)*

- Contrasting porcelain tile finishes to walls and floor (Porcelanosa X-Light Basic Snow high-gloss/X-Light Basic Dark matt)
- Solid surface single sink and vanity with integrated drawer, designed by Odile Decq
- Wall-mounted Dornbracht single-lever mixer tap in chrome, full-width mirror to vanity, recessed LED lighting above vanity
- Floor-level walk-in shower with tempered, gradient glass screen
- Ceiling-mounted Dornbracht 220mm rain shower with handset in chrome
- Wall-mounted 'In Tank' toilet with integrated cistern

##### *Floor 02-07*

- Porcelain tile finishes to walls and floor (Porcelanosa X-Light Basic Snow high-gloss/X-Light Basic Snow matt); selected residences with feature wall in X-Light Savage Dark high-gloss
- Solid surface single or double sink and vanity with integrated drawers, designed by Odile Decq
- Full-width mirror to vanity
- Recessed LED lighting

- Wall-mounted Dornbracht single- or double-lever mixer tap in polished chrome
- Solid surface baths designed by Odile Decq in master bedrooms with freestanding Dornbracht single-lever tub mixer
- Floor-level walk-in shower with gradient tempered glass screen
- Ceiling-mounted Dornbracht 'Just Rain' shower panel with handset and individual shower heads in master bedrooms and guest rooms, 220mm rain shower with handset in polished chrome

##### *Floor 08-18*

As previous with the following enhancements:

- Master bathrooms with natural marble
- Other bathrooms fully finished with X-Light Lush White high-gloss or with a feature wall in X-Light Savage Dark high-gloss, with ceiling-mounted Dornbracht rain showers (400mm or 220mm) and hand shower set

##### *Floor 19-21*

As previous with the following enhancements:

- Master bathrooms with natural marble
- Solid surface baths by Odile Decq in second bedrooms with X-Light Lush White high-gloss and feature wall in X-Light Savage Dark high-gloss
- Other bathrooms and powder rooms fully finished with X-Light Lush White high-gloss
- Ceiling-mounted Dornbracht 'Just Rain' shower panel with handset and individual shower heads in polished chrome

##### *Duplex and Penthouse Residences*

As previous with the following enhancements:

- All bathrooms and ensuites in natural marble

#### INTERIOR FINISHES

- Walls and ceilings finished in white matt paint
- Built-in or surface wardrobes by Carré incorporating handleless white lacquered doors (fitted internally with rails, shelves and LED lighting)
- Multi-point locking, timber front door by Carré with exterior handle and outside finish in lacquered black matt
- Interior doors and mouldings lacquered in white, invisible hinges, brass handle designed by Odile Decq
- High-quality bamboo timber flooring in living rooms, bedrooms, kitchens and corridors

#### EXTERNAL FINISHES

- Façade with terraces: full-height glazing and sliding door system to terraces
- Curtain walls: operable windows

#### TERRACES

- Bespoke outdoor terraces with bamboo decks
- Curved glass balustrade
- LED lighting
- Water outlet
- Electrical sockets

#### COMMON AREAS

- Triple-height entrance lobby with curved feature wall, bespoke concierge desk and residents' lounge area, boasting a full-height green wall extending into the garden, along the dividing wall of the neighbouring SB Hotel. Polished concrete with black quartz powder flooring throughout
- High-quality bamboo flooring to lift lobbies and residential corridors
- Residential corridors and landings include bespoke curvilinear LED lighting
- Smoke detection and sprinkler system throughout

#### PARKING

- Floor 01: designated open space
- Floor 02-06: designated open space and storage unit
- Floor 07: one-car garage with integrated storage unit
- Floor 08-18: two-car garage with integrated storage unit
- Floor 19 and above: three-car garage with integrated storage unit

#### AMENITIES

- Sky Terrace & Rooftop infinity pool with 360° unobstructed views of Barcelona and the Mediterranean Sea
- Fully landscaped garden with Paddle Court
- Garden pavilion equipped with virtual golf simulator
- Cinema room with break-out area and kitchen console
- Generous wellness area (1,000 sq m) with natural lighting and green wall, comprising:
  - Fully equipped Technogym fitness centre with free weights and cardio machines
  - Indoor pool (17m length) and jacuzzi
  - Yoga pod
  - Bespoke steam rooms and sauna
  - Spa treatment rooms
  - Relaxation area with infrared thermal loungers
  - Locker rooms

#### INTELLIGENT HOME SYSTEMS

- Smartphone-controlled Gira home automation system with control screen and integrated video intercom; voice and data outlets throughout
- Smoke detection in each home and sprinklers throughout

#### HEATING & COOLING

- Temperature control integrated in-home automation system
- Urban distribution network by Districlima for heating, cooling and domestic hot water

## THE ARCHITECT **STUDIO ODILE DECQ**

French-born Odile opened her first studio in 1978. A decade later, her Banque Populaire de l'Ouest in Rennes won 11 awards. Since then, highlights have included the Venice Biennale Golden Lion 1996, Maison&Objet Designer of the Year 2013, the Jane Drew Prize for women in architecture 2016, and Architizer's Lifetime Achievement Award 2017. Now globally recognised, Odile still works from her studio in Paris, and continues to create landmarks through her unique, cutting-edge yet sensual architecture.

She was awarded for being “a creative powerhouse, spirited breaker of rules and advocate of equality”. Her diverse portfolio ranges from art galleries and museums, to social housing and infrastructure.

## INTERIOR DESIGNER **HIRSCH BEDNER ASSOCIATES (HBA)**

HBA creates inspired, brand-strengthening design experiences that evoke a distinct sense of place and delight for even the most discerning individuals. Around the globe, HBA consistently sets new standards for luxury, comfort and innovation in interior design.

## A DEVELOPMENT BY **SHAFTESBURY**

Shaftesbury Asset Management is a continental European real estate Investment and Fund Manager. The group was first established in 1983 as a property development company investing in France, Germany and Spain.

Since then, and in addition to developing its Investment and Fund Management activities, the group has continued to be active as a property developer, broadly diversified as to property types (offices, logistics, retail, residential, etc), as well as geographically (the UK, France, Germany, Spain and Italy, etc).

Shaftesbury's approach has always been to think outside the box, innovate and concentrate on getting the timing right, and then to bring the group's professionalism to bear to produce the best building in the market at the right moment.

**Shaftesbury**  
ASSET MANAGEMENT

These details have been prepared in good faith but are not intended to constitute part of any offer of contract or create any contractual relationship. No description or information of any kind contained in these particulars may be relied upon as a statement or representation, warranty or fact. All images (including computer-generated images), plans and specifications shown are indicative only, cannot be guaranteed to represent the complete interiors or exteriors of the project and are subject to change due to design coordination and other development considerations. Any areas, measurements or distances given are approximate only. Any buyer must satisfy themselves by inspection or otherwise as to the correctness of any information given. These properties are offered subject to availability. Neither Shaftesbury RE Diagonal 0, S.L., nor any of the agents participating in the development and commercialisation process of the project guarantee the veracity, exactness or completeness of the information contained herein and shall not be held liable for its content.

Designed & produced by Sectorlight (1707497), +44 (0)20 7264 7700, sectorlight.com, 10/2019

